



Kent Academic Repository

Korolija Fontana-Giusti, Gordana *The Importance of Good Design*. In: *Cityscape 2007 - Interdisciplinary Conference, February 2007, London, Earls Court*. (Unpublished)

Downloaded from

<https://kar.kent.ac.uk/14920/> The University of Kent's Academic Repository KAR

The version of record is available from

This document version

UNSPECIFIED

DOI for this version

Licence for this version

UNSPECIFIED

Additional information

This was a well attended major national and international annual event which included exhibition and a conference. The focus of the paper was on the arts and their contribution to the urban environment.

Versions of research works

Versions of Record

If this version is the version of record, it is the same as the published version available on the publisher's web site. Cite as the published version.

Author Accepted Manuscripts

If this document is identified as the Author Accepted Manuscript it is the version after peer review but before type setting, copy editing or publisher branding. Cite as Surname, Initial. (Year) 'Title of article'. To be published in *Title of Journal*, Volume and issue numbers [peer-reviewed accepted version]. Available at: DOI or URL (Accessed: date).

Enquiries

If you have questions about this document contact ResearchSupport@kent.ac.uk. Please include the URL of the record in KAR. If you believe that your, or a third party's rights have been compromised through this document please see our [Take Down policy](https://www.kent.ac.uk/guides/kar-the-kent-academic-repository#policies) (available from <https://www.kent.ac.uk/guides/kar-the-kent-academic-repository#policies>).

The Importance of Good Design

presentation by Dr. Gordana Fontana-Giusti

URBAN DESIGN Unit

ARTS *for* the CITY



The Innovation Centre, Central Saint Martins

28 February 2007

Cityscape London

University of the
Arts London * *
Central
Saint Martins *
*

URBAN DESIGN Unit

ARTS *for* the CITY



- **ARTS *for* the CITY** combines the knowledge of **architectural theory** with the experience of **art** practice
- **ARTS *for* the CITY** interprets the practice of art for **architecture** and **urban design**

URBAN DESIGN Unit

ARTS *for* the CITY



The Importance of Good Design G. Fontana-Giusti

University of the
Arts London
Central
Saint Martins

URBAN DESIGN Unit

ARTS *for* the CITY



METROPOLIS TODAY

- in the state of enduring **self-examination**
- resurrection of interests in everything **urban**
- coupled with the concern for the **environment**

University of the
Arts London
Central
Saint Martins

URBAN DESIGN Unit

ARTS *for* the CITY



METROPOLIS TODAY



- new series of **questions** and **speculations** about the metropolitan life emerge daily
- “we have not been here before”

The Importance of Good Design G. Fontana-Giusti

University of the
Arts London * *
Central * *
Saint Martins *
*

URBAN DESIGN Unit ARTS *for* the CITY

METROPOLIS TODAY



- the aim is to encapsulate these previously not lived through urban **experiences**
- **good design relates** to these occurrences

The Importance of Good Design G. Fontana-Giusti

University of the
Arts London
Central
Saint Martins

URBAN DESIGN Unit
ARTS *for* the CITY
METROPOLITAN
EXPERIENCES

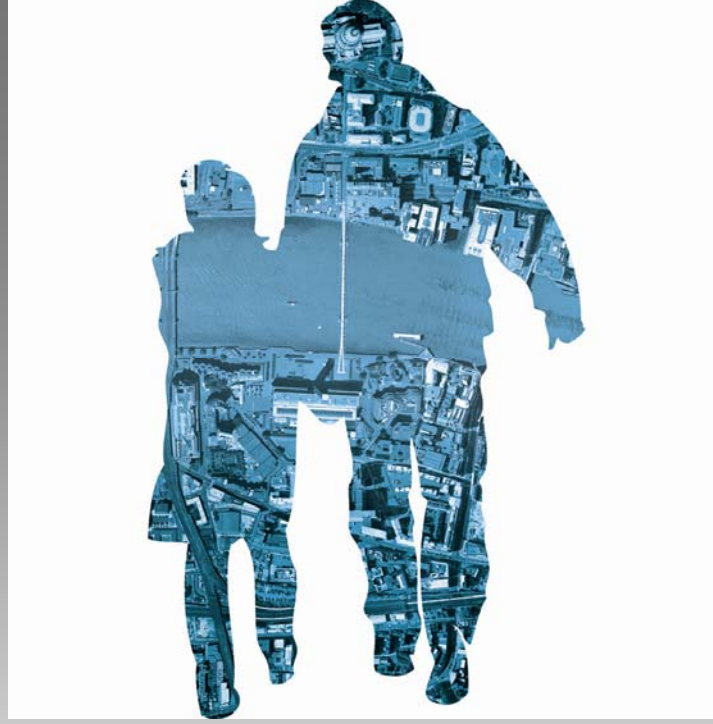

- urban experiences are always **layered** and **multifaceted**
- often they appear as traces and fragments of images, sounds, tastes, textures, smells and narratives
- they are linked to city spaces that thus gain their **significations**, their **meanings** for us

URBAN DESIGN Unit

ARTS *for* the CITY



The Importance of Good Design G. Fontana-Giusti

University of the
Arts London
Central
Saint Martins

URBAN DESIGN Unit ARTS *for the CITY*



translating **METROPOLITAN**
EXPERIENCES into design



- in *ARTS for the CITY* we aim at **understanding, analyzing** and **mapping** these processes whereby **meanings emerge**
- as urban **design** is involved in the production of this phenomena making it **good** is essential



URBAN DESIGN Unit

ARTS *for* the CITY



METROPOLITAN EXPERIENCES

- We talk about ‘experience’ because it embodies ‘function’ and the ‘aesthetic pleasure’
- Vital role for the arts in conversing with the City space
- **ARTS *for* the CITY** is a **conduit** that communicates the knowledge derived from the arts into the city
- **ARTS *for* the CITY *assists* the architects and *city planners***

URBAN DESIGN Unit

ARTS *for* the CITY

Projects:

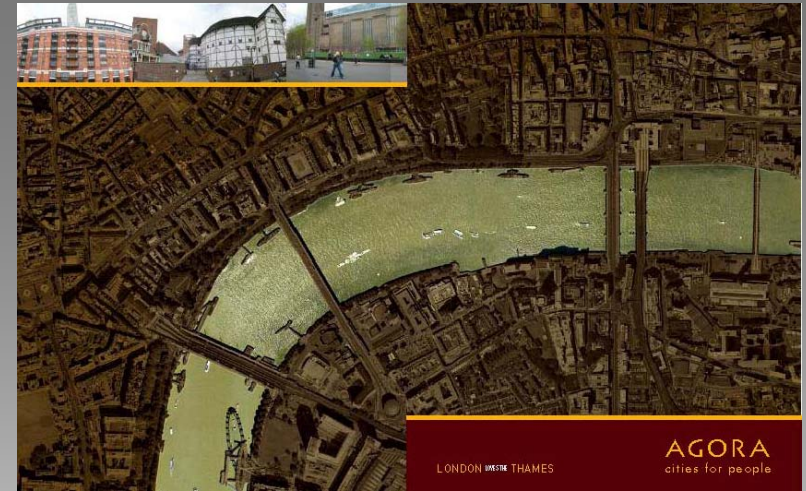

AGORA Cities for People – European Commission Framework 5
London Loves the Thames - London Biennale of Architecture 2006
Bridging London – current proposal for a textile bridge

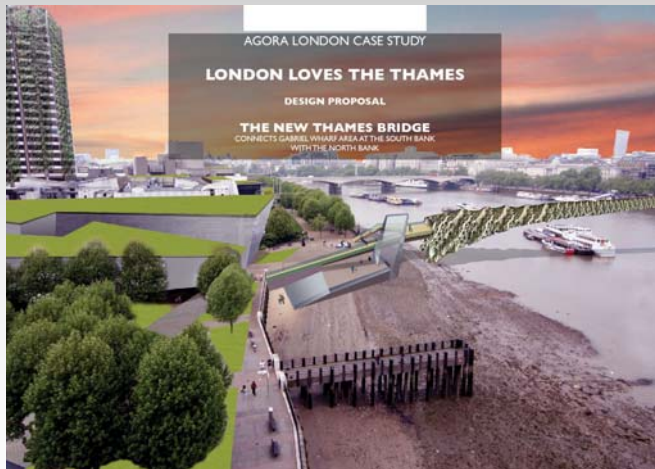

The Importance of Good Design

G. Fontana-Giusti

Saint Mar



URBAN DESIGN Unit

ARTS *for* the SUSTAINABLE CITY

AGORA Cities for People – European Commission Framework 5



University of
Arts London
Central
Saint Martins

The Importance of Good Design

G. Fontana-Giusti



LONDON CAPITAL ROUTE

AGORA
cities for people

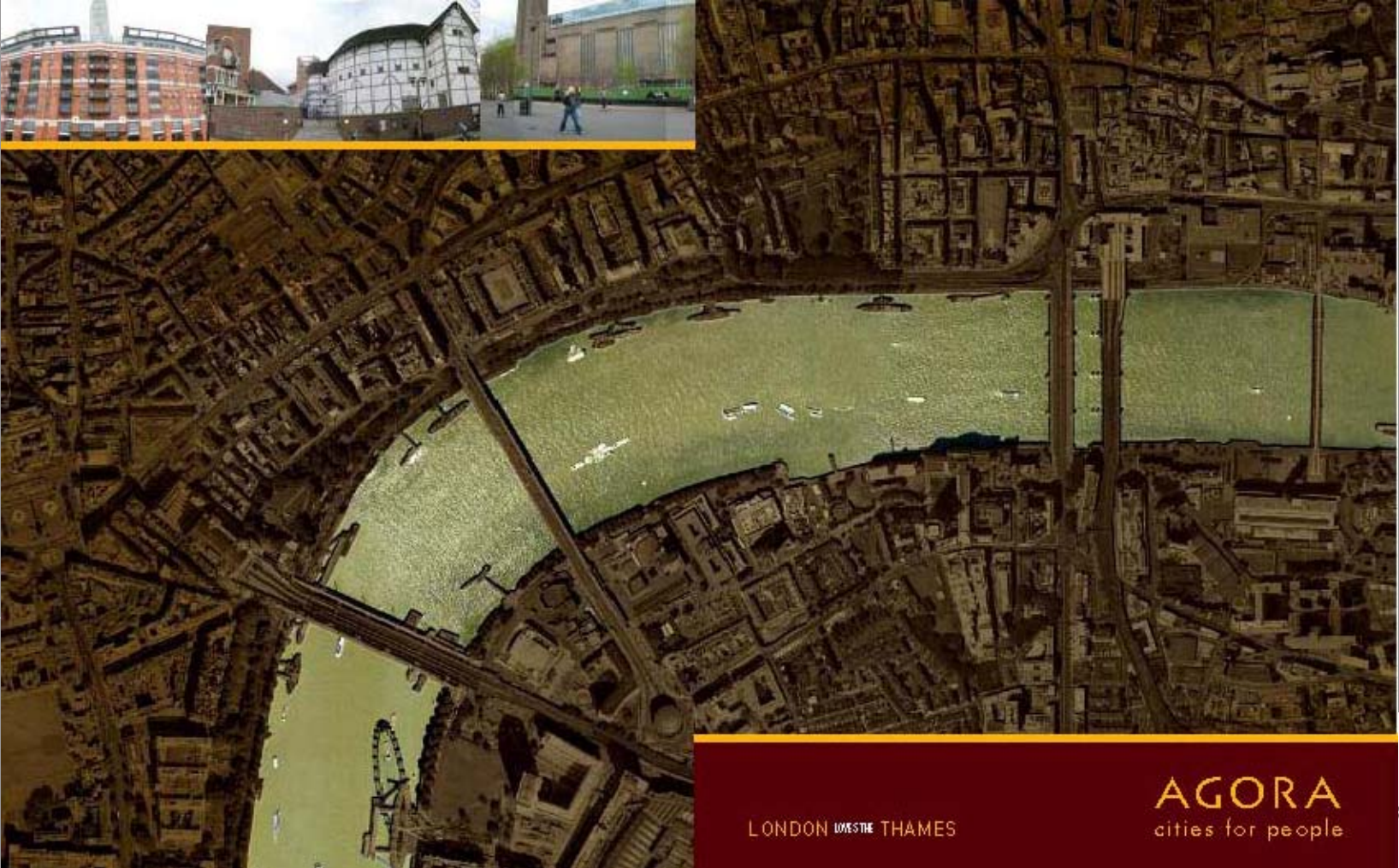

LONDON LOVE THE THAMES

AGORA
cities for people

University of London
Arts London
Central Saint Martins



URBAN DESIGN Unit

ARTS *for* the CITY



- **A pan-European audit methodology**
- AGORA has developed and tested a unique pan-European audit methodology that can contribute to analysis and development of a better understanding of the ways in which planning, design and policy making decisions affect the built environment in particular in relation to **pedestrian life in city centres**. AGORA's hypothesis has proposed that with such an understanding, a better quality of life for pedestrians can be achieved thus contributing to the **sustainability** agenda of the cities – the AGORA addresses sustainability concerns are for the **environment, the society** and **the individual**.

University of the
Arts London * *
Central
Saint Martins * *
* *

URBAN DESIGN Unit

ARTS *for* the CITY

represents a **comparable** sample of the city, a '**transect**'-
which deals with all aspects of urban life.

contains rich **pedestrian flows**

is an urban interface with a variety of **public spaces**, civic
and public buildings

is a **representative** sample of the identity of the city

contains key aspects of **streetscape** that support best
functioning of public life

contains a variety of **symbolic** meanings



URBAN DESIGN Unit

ARTS *for* the CITY



The Importance of Good Design

G. Fontana-Giusti

Saint Maru *



LONDON CAPITAL ROUTE – HISTORICAL REFERENCES

AGORA
for people



The Adam brothers' Adelphi Terrace on the Thames.

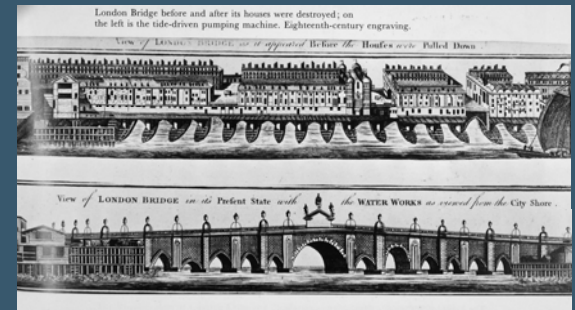

London Bridge before and after its houses were destroyed; on the left is the tide-driven pumping machine. Eighteenth-century engraving.

View of LONDON BRIDGE as it appeared Before the Houses were Pulled Down

View of LONDON BRIDGE in its Present State with the WATER WORKS as viewed from the City Shore.

17th century Transgression – Going South of the River



17th century Ice feast

18th century visions of the riverside

17th century visions of the riverside by Hollar

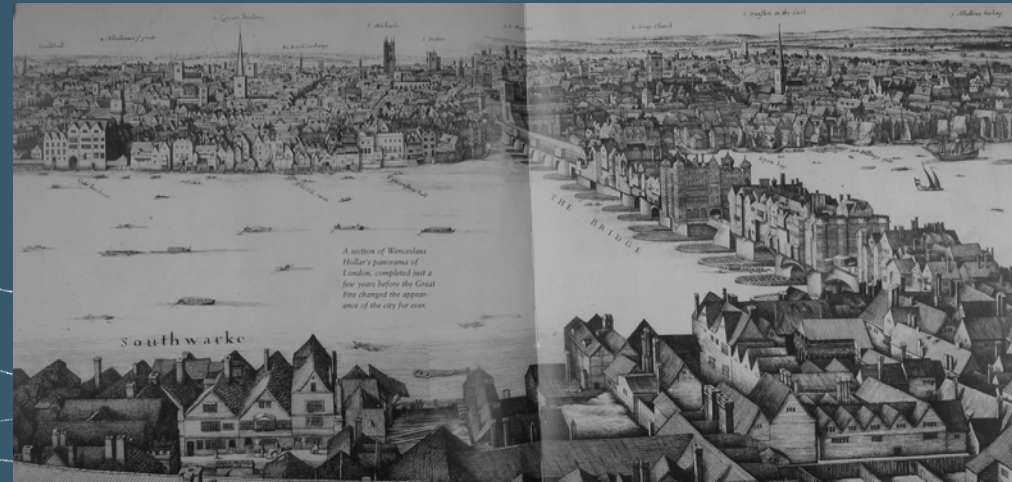

A section of Wenceslaus Hollar's panorama of London, completed just a few years before the Great Fire changed the appearance of the city for ever.

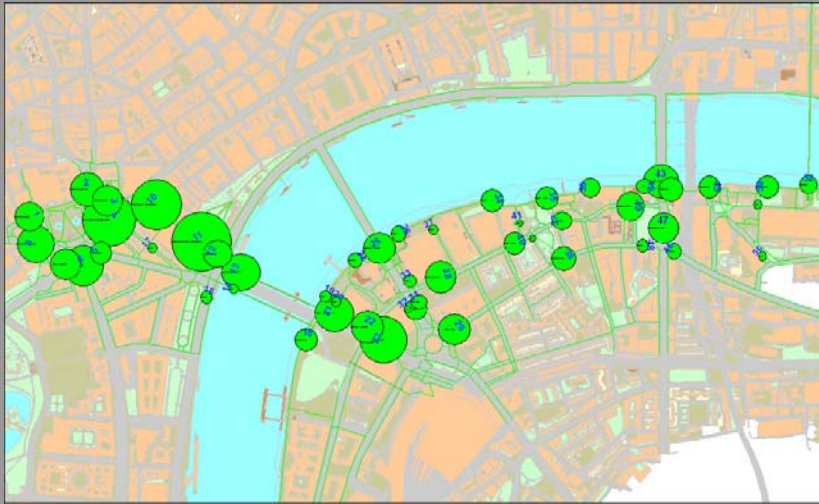

Volume of Pedestrian Flows

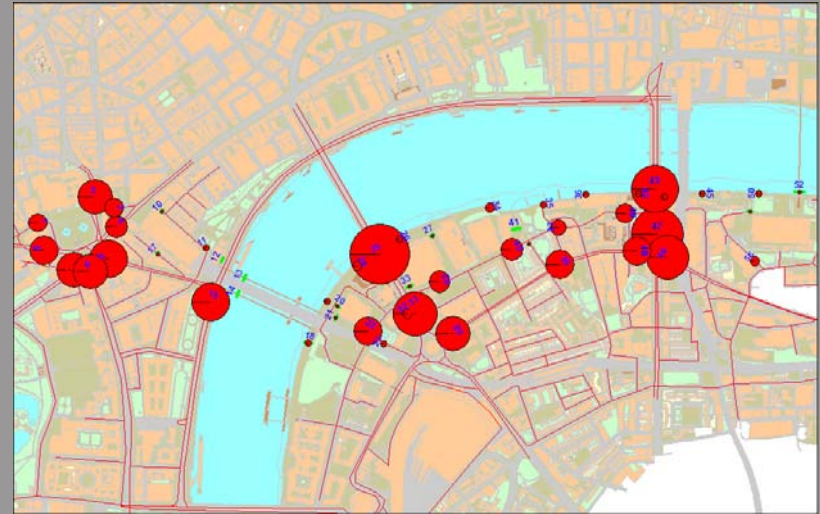

Volume of Vehicular Flows

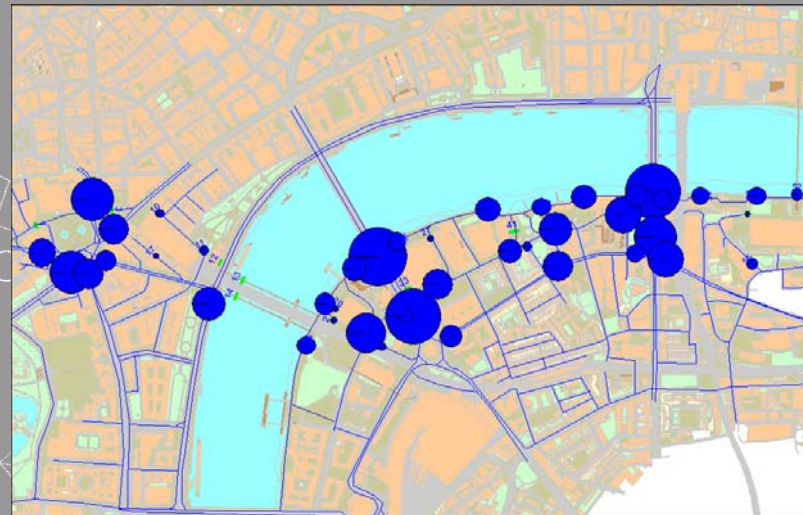

Volume of Cyclist Flows



LONDON CAPITAL ROUTE ASSEMBLAGES



SELLING ASSEMBLAGE



VIEWING ASSEMBLAGE



BUYING ASSEMBLAGE



EATING ASSEMBLAGE



TALKING/ VIEWING ASSEMBLAGE



SHOPPING ASSEMBLAGE

LONDON CAPITAL ROUTE - URBAN ROOMS

AGORA
cities for people

STORY BOARD, ROOM-1 OXO TOWER



STORY BOARD, ROOM-2 FALCON POINT



STORY BOARD, ROOM-3 WEST OF TATE

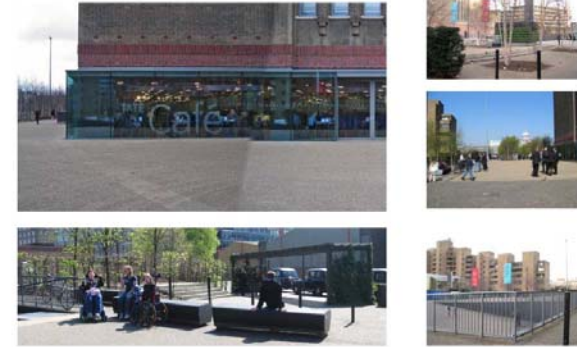

STORY BOARD, ROOM-4 GLOBE BANKSIDE



STORY BOARD, ROOM-5 NEW GLOBE WALK



Saint M.    

LONDON CAPITAL ROUTE – URBAN ROOMS

AGORA

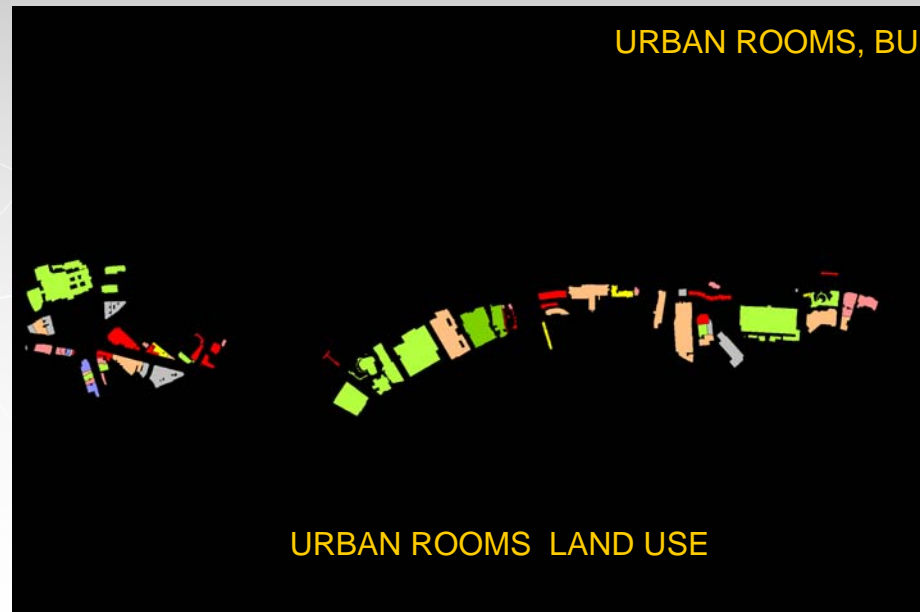
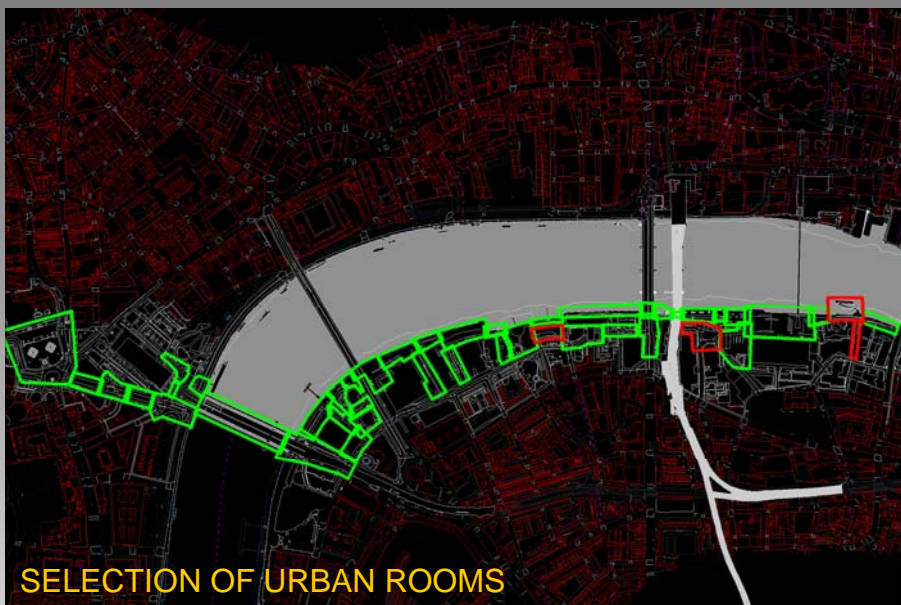

URBAN ROOMS LAND USE



The Globe area

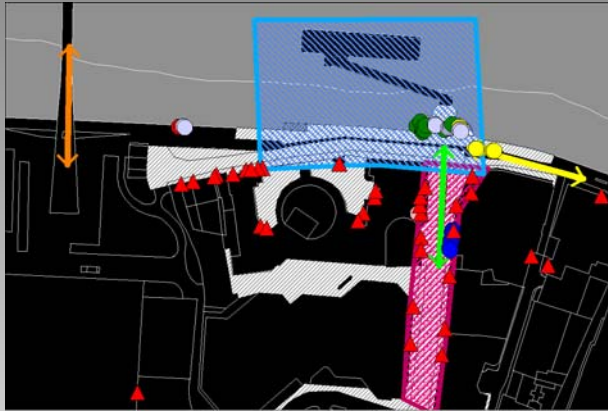

Tate West area



ANALYSIS of the pedestrian flows entrances and shape of the urban room



OXO tower area



Conclusion of the Analysis

The issues diagnosed by the implementation of the analysis are

1. More space for pedestrians

2. Cyclists Path

3. More green areas

4. Water features to relate to the river

Design proposals:
to evolve and develop by visualization,
modeling and responsive design



University of the
Arts London
Central
Saint Martins

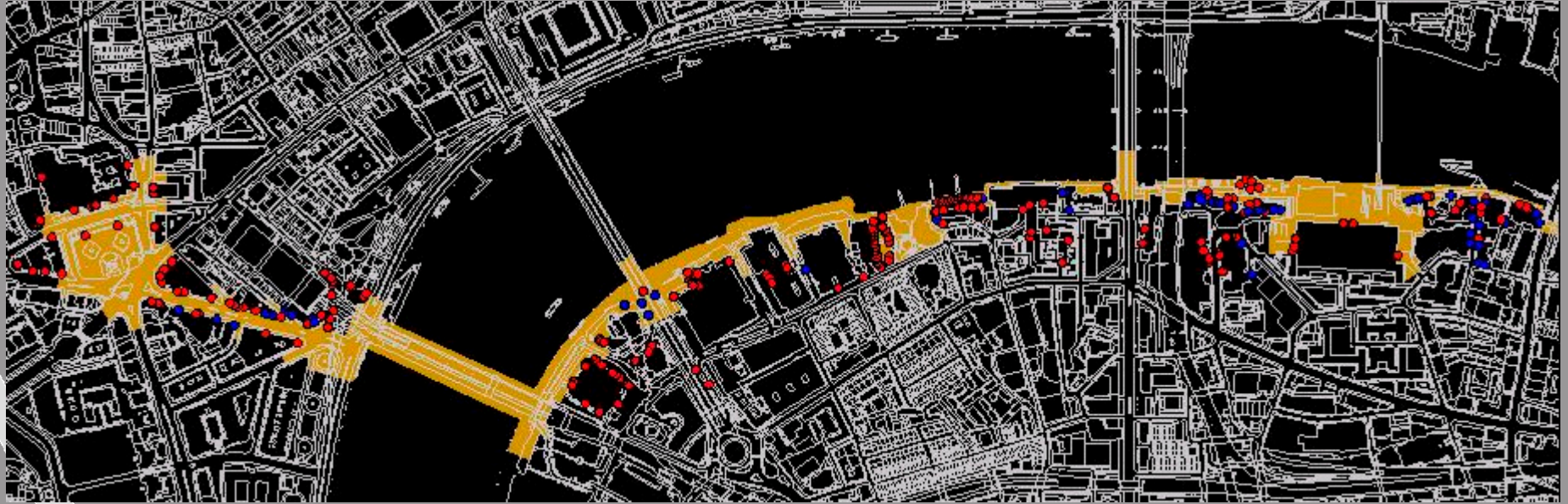

URBAN WALL- ACCESIBLE SPACE WITH ENTRANCES PUBLIC / PRIVATE

University of the
Arts London
Central
Saint Martins

LONDON CAPITAL ROUTE
CONCLUSION OF THE ANALYSIS

1. PEDESTRIAN PATHS Narrow NEED FOR EXTENSION
2. NEED FOR SEPARATE CYCLIST PATH
3. MORE GREEN AREAS
4. WATER AS SUSTAINABILITY FEATURE

AGORA
cities for people

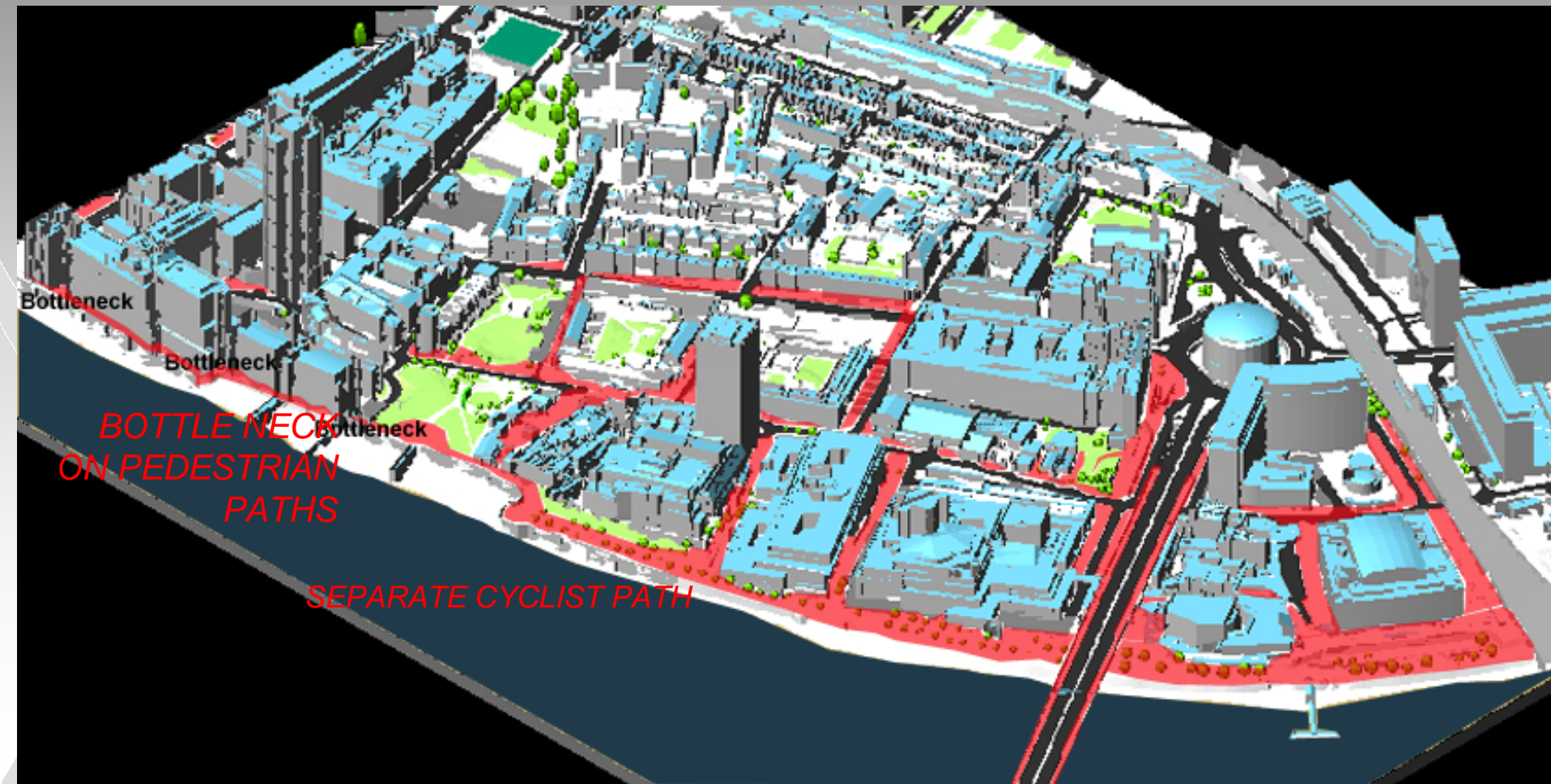

More space for pedestrians

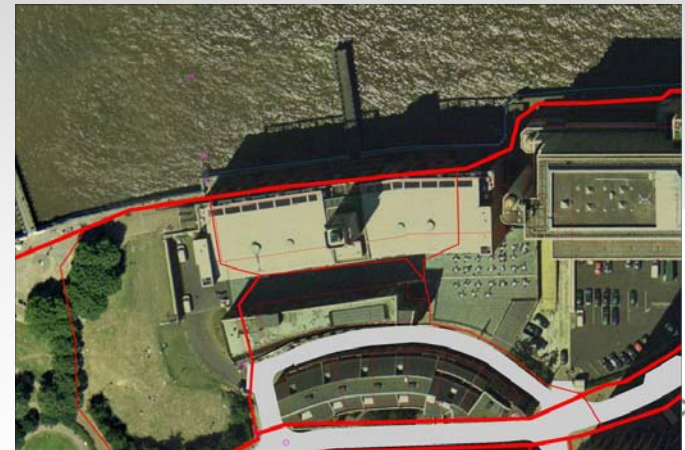
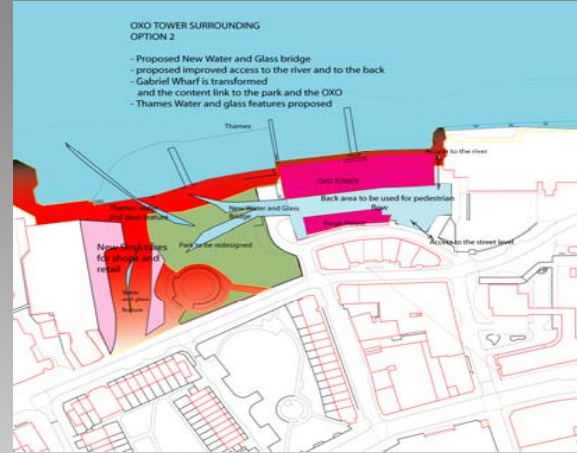

title

03 August 2006

DESIGN PROPOSAL ROUTE EXTENDS TO THE BACK OF OXO TOWER

LONDON CAPITAL ROUTE

1. DESIGN PROPOSAL GLASS BRIDGE TO THE BACK OF THE OXO

AGORA
cities for people



title

03 August 2006

DESIGN PROPOSAL - ROUTE EXTENDS TO THE BACK OF OXO

University of
Arts London
Central
Saint Martins





Cyclists Path
possibly to include the path at the back of
the OXO and along the Upper Ground to
the Tate Globe and the Borough Market
Path develops in parallel to the Thames
On the Bridges: separate, physically
articulated Cyclist path to eliminate the
death spot

Cyclists death spot



03 August 2006

Contradiction in Cyclists Routes – from Tate to Oxo

University
Arts London
Central
Saint Martins

*

*



Horticultural Interventions ROOF GARDENS



LONDON CAPITAL ROUTE

4. DESIGN PROPOSAL WATER INSTALLATION

WATER INSTALLATION ON THE PEDESTRIAN ROUTE addresses
Concerns for the sustainability of the river Thames and
Provides an optical feature for the public

AGORA
cities for people

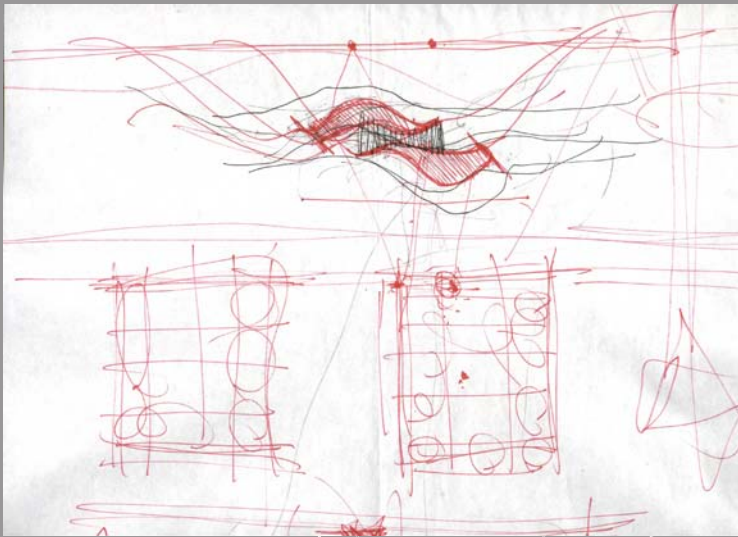

Installation – initial sketch



LONDON CAPITAL ROUTE

Strategic Design

CONCLUSION AND WORK IN PROGRESS

Southbank and Bankside need for the stronger connection

Proposal: creation of the link under the Blackfriars

Overlay sketch indicates the continuity of the parallel path



URBAN DESIGN Unit

ARTS *for the CITY*

The Importance of Good Design G. Fontana-Giusti

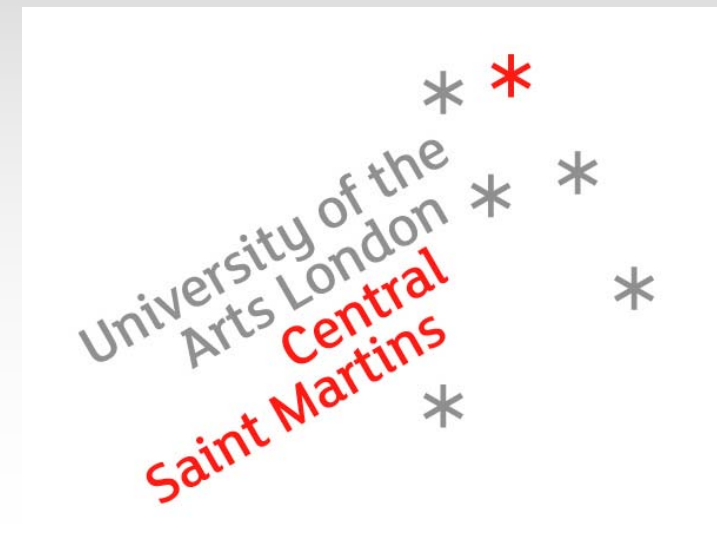

AGORA
cities for people

AGORA: CITIES FOR PEOPLE
RESEARCH PROJECT FOCUSING ON PLANNING AND SUSTAINABILITY OF THE SOUTH BANK, LONDON.
CENTRAL SAINT MARTINS COLLEGE OF ART & DESIGN

A visual representation of the AGORA: Cities for People
research project focusing on planning and sustainability of the South Bank, London.

LONDON LOVES THE THAMES

AN EXHIBITION FOR THE LONDON ARCHITECTURE BIENNALE BY URBAN DESIGN,
AT THE INNOVATION CENTRE, CENTRAL SAINT MARTINS COLLEGE OF ART & DESIGN

University of the
Arts London * *
Central * *
Saint Martins * *



AGORA LONDON CASE STUDY

LONDON LOVES THE THAMES

DESIGN PROPOSAL

THE NEW THAMES BRIDGE
CONNECTS GABRIEL WHARF AREA AT THE SOUTH BANK
WITH THE NORTH BANK





Presentation title

03 August 2006

University of the
Arts London * *
Central * *
Saint Martins * *